



Redmayne Arnold & Harris
estate agents, letting agents & surveyors

rah.co.uk



TO LET



2 Limetree Close, Cambridge, CB1 8PF

£1,775 PCM

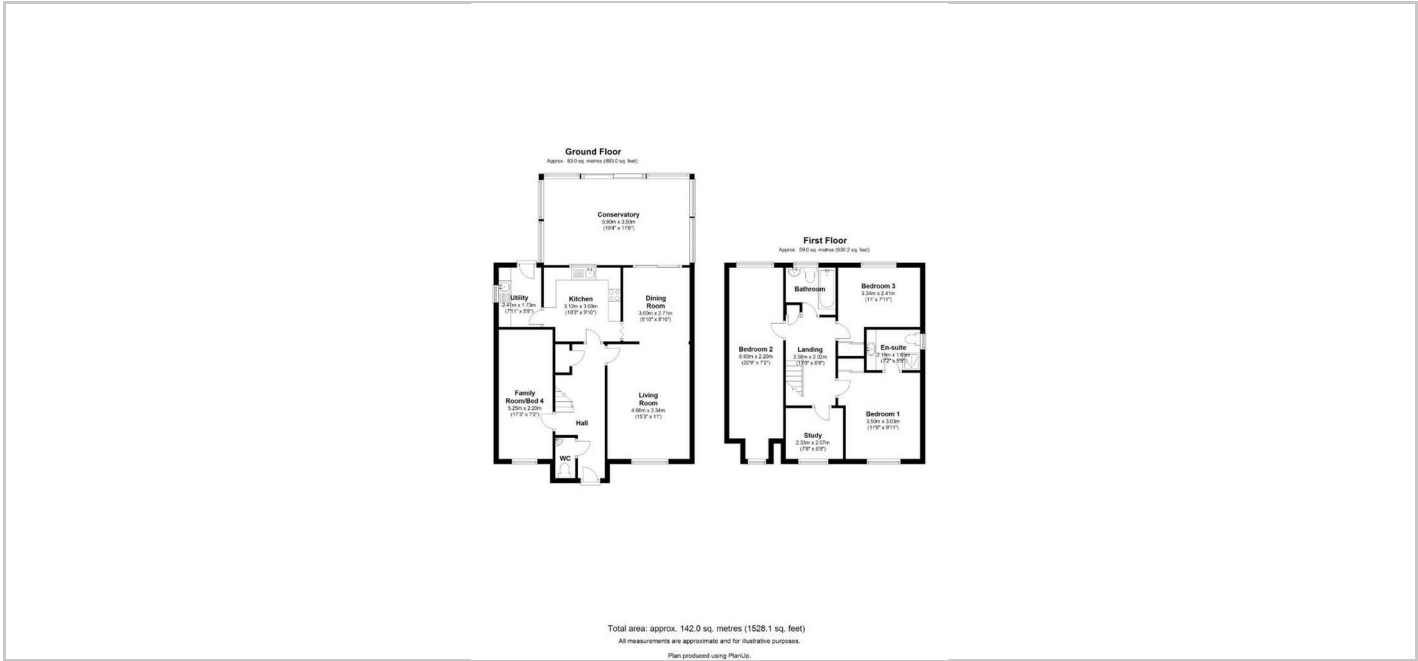

Directions

THE PROPERTY

A detached, part-furnished three bedroom house, situated to the south of the City Centre and providing easy access to Addenbrookes Hospital and the railway station. The property comprises entrance hall, WC, open-plan living / dining room, family room / potential fourth bedroom, conservatory, kitchen and utility room to the ground floor. To the first floor, there is the master bedroom with en-suite shower room, two further bedrooms, study and family bathroom. There is an off-road parking area for two cars. The property also benefits from a large enclosed garden to rear. The property will be managed by RAH. Council Tax Band - E. EPC Rating - D.

SITUATION

